

**MTW 250i /FSC/3,5m/45°**

**4,035,945**

# MTW 250i /FSC/3.5m/45° (4,035,945)

## MTW / MHP W ML

### TAB. B

44,0350,3436 - 3,15m (10.33ft)	MTW 250i & MTW 400i
44,0350,3437 - 4,15m (13.61ft)	

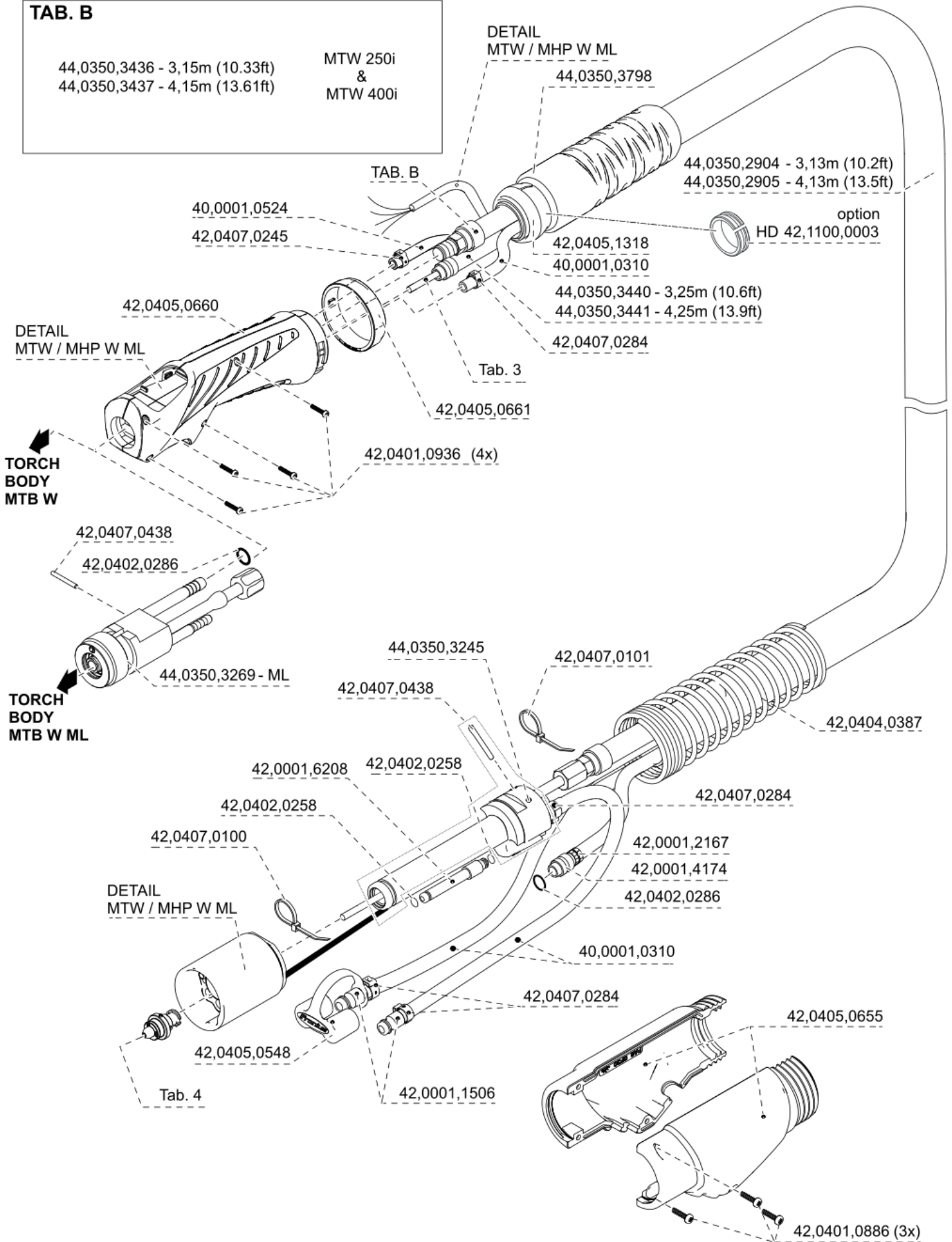

# MTW 250i /FSC/3.5m/45° (4,035,945)

## DETAIL MTW-MHP W ML

### STANDARD LED

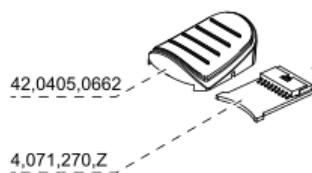

### UP/DOWN LED

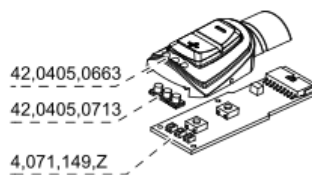

### JM LED

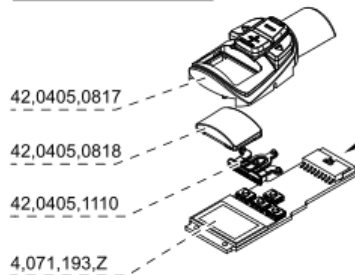

### POTI LED



connect

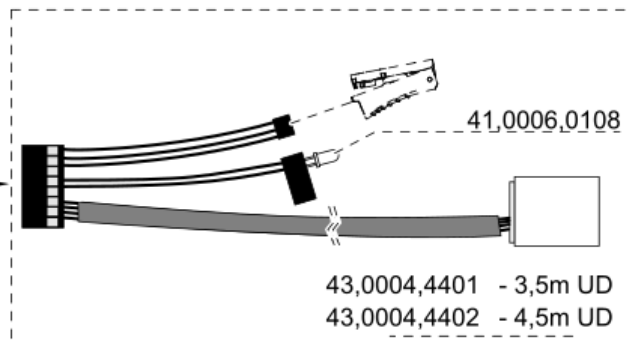

### STANDARD

43,0004,4073 - 3,5m  
43,0004,4074 - 4,5m

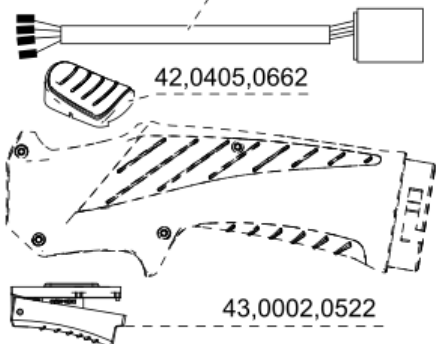

### TORCH TRIGGER - only standard

42,0405,0671 TT

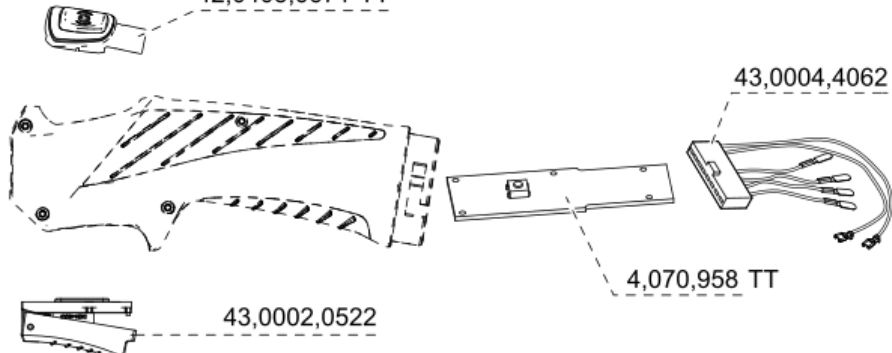

# MTW 250i /FSC/3.5m/45° (4,035,945)

OPT/i T-Handle SET for Push 44,0350,5298

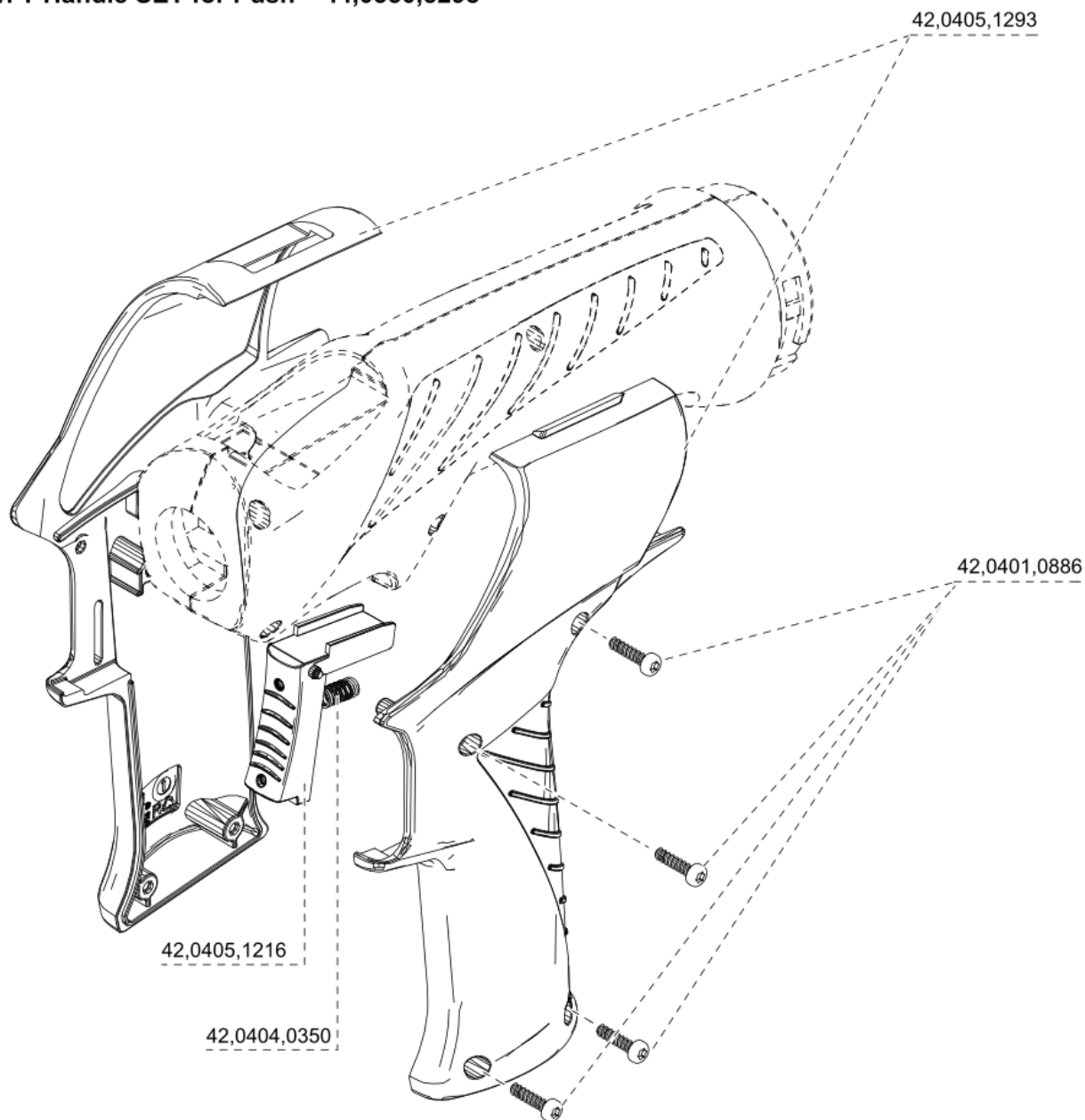

## OPT/i Button extension kit

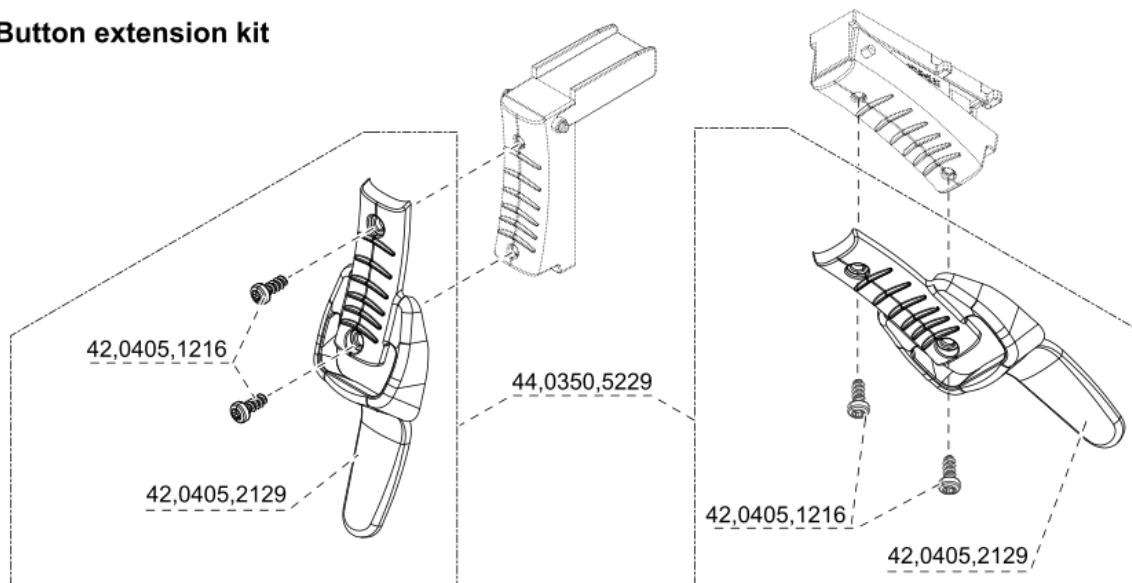

# MTW 250i /FSC/3.5m/45° (4,035,945)

## MTW 250i

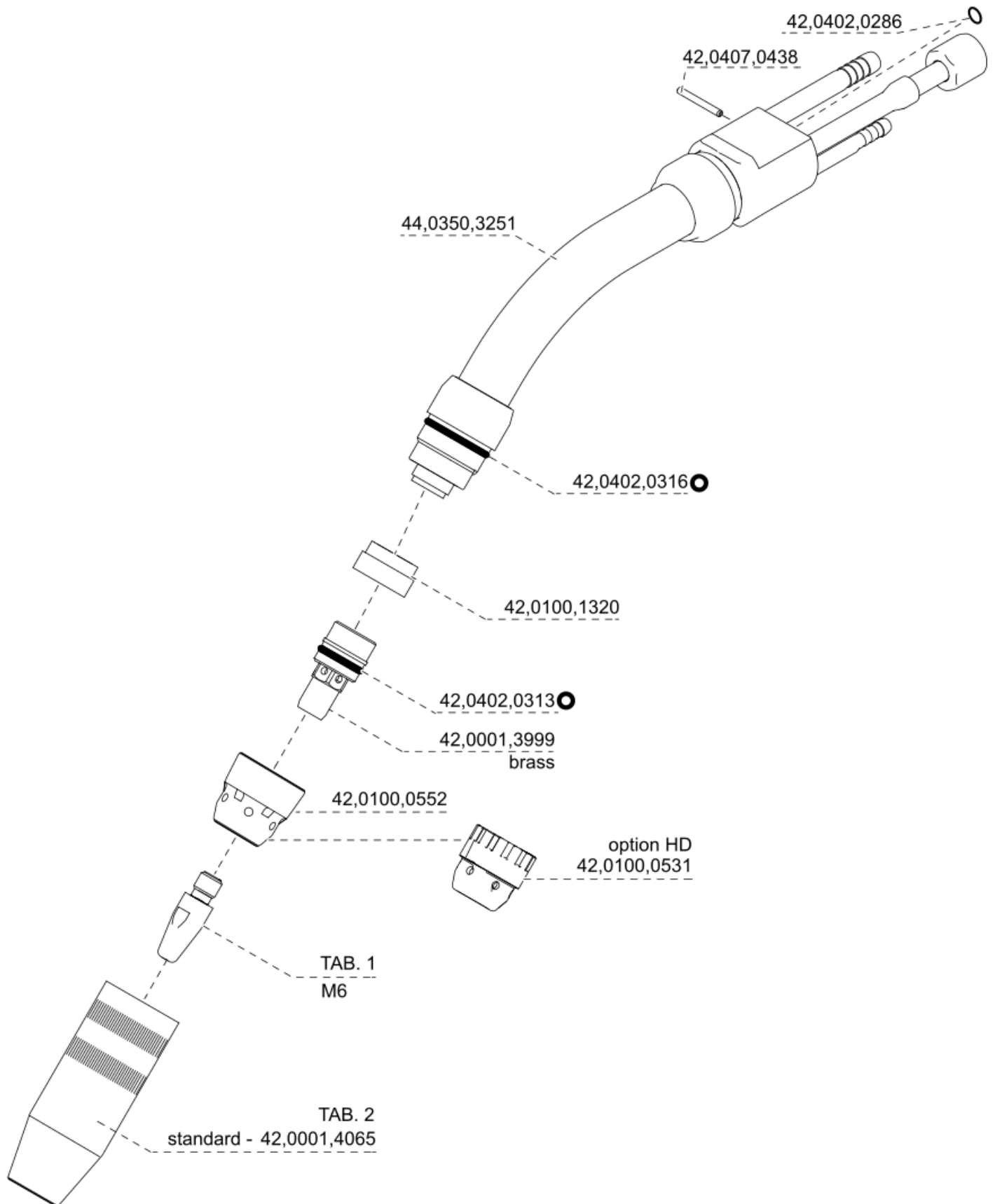

# MTW 250i /FSC/3.5m/45° (4,035,945)

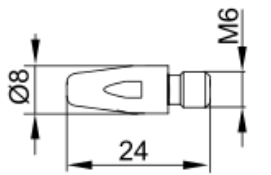
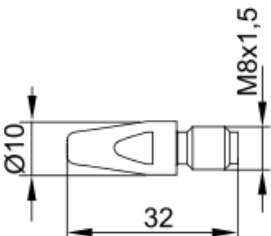
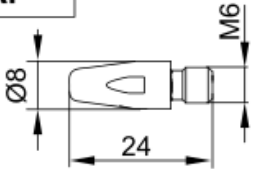
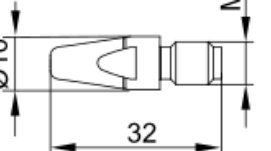
TAB. 1 <b>CuCrZr</b>		Ø mm	Ø inch	Part No.
		0,6	0,023	42,0001,4928
		0,7	0,027	42,0001,6524,10
		0,8	0,030	42,0001,4461,10
		0,9	0,035	42,0001,4462,10
		1,0	0,040	42,0001,4463,10
		1,1	0,043	42,0001,6527,10
		1,2	0,045	42,0001,4464,10
		1,3	0,051	42,0001,6529,10
		1,4	0,052	42,0001,4465,10
		1,5	0,059	42,0001,6522,10
		1,6	0,062	42,0001,4466,10
		0,7	0,027	42,0001,6482,10
		0,8	0,030	42,0001,6464,10
		0,9	0,035	42,0001,6465,10
		1,0	0,040	42,0001,6466,10
		1,1	0,043	42,0001,6483,10
		1,2	0,045	42,0001,6467,10
		1,3	0,051	42,0001,6484,10
		1,4	0,052	42,0001,6468,10
		1,5	0,059	42,0001,6485,10
		1,6	0,062	42,0001,6469,10
		1,8	0,071	42,0001,6470,10
	2,0	0,078	42,0001,6471,10	
	2,4	0,095	42,0001,6472,10	
	2,8	0,110	42,0001,4642,10	
<b>Al</b> 		0,8	0,030	42,0001,6525,10
		1,0	0,040	42,0001,6526,10
		1,2	0,045	42,0001,6528,10
		1,6	0,062	42,0001,6523,10
<b>Al</b> 		0,8	0,030	42,0001,6537,10
		1,0	0,040	42,0001,4750,10
		1,2	0,045	42,0001,4751,10
		1,6	0,062	42,0001,4752,10

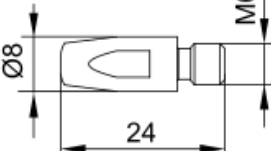
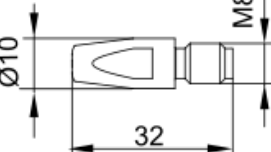
TAB. 1 <b>E-Cu</b>		Ø mm	Ø inch	Part No.
		0,9	0,035	42,0001,7025,10
		1,0	0,040	42,0001,7026,10
		1,2	0,045	42,0001,7027,10
		0,9	0,035	42,0001,7028,10
		1,0	0,040	42,0001,7029,10
		1,2	0,045	42,0001,7030,10



# MTW 250i /FSC/3.5m/45° (4,035,945)

**TAB. 2**

		d1		d2		d3		L		Part No.			
		mm	inch	mm	inch	mm	inch	mm	inch				
MTW 250i	MTG 250i	M20x2											
		8	0.31	22	0.86	10,4	0.41	58	2.28	42,0001,6664			standard MTW 250i Braze
		10	0.39	22	0.86	13,0	0.51	54	2.13	42,0001,4083			
		13	0.51	22	0.86	16,1	0.63	54	2.13	42,0001,4799			
		13	0.51	22	0.86	16,1	0.63	56	2.20	42,0001,4477			standard MTB 250i G/W R
		10	0.39	22	0.86	13,0	0.51	58	2.28	42,0001,4084			
		13	0.51	22	0.86	16,1	0.63	56	2.20	42,0001,4498	AI		
		13	0.51	22	0.86	16,1	0.63	58	2.28	42,0001,4065			standard MTG/MTW 250i
		15	0.59	22	0.86	18,3	0.72	58	2.28	42,0001,4493			
		18	0.71	22	0.86	22	0.87	58	2.28	42,0001,4055			
MTW 400i/500i	MTG 320i/400i	M23x2											
		13	0.51	25	0.98	16,4	0.64	59	2.32	42,0001,4085			
		15	0.59	25	0.98	18,6	0.73	59	2.32	42,0001,4048			
		13	0.51	25	0.98	16,4	0.64	61	2.40	42,0001,4086			standard MTB 320i G R
		15	0.59	25	0.98	18,1	0.71	61	2.40	42,0001,4474			standard MTB 400i W R
		15	0.59	27	1.06	20,2	0.80	61	2.40	42,0001,4789			MTB 400i W R, heavy duty
		17	0.71	25	0.98	20,8	0.82	61	2.40	42,0001,4476			standard MTB 500i W R
		13	0.51	25	0.98	16,4	0.64	61	2.40	42,0001,4497	AI		
		13	0.51	25	0.98	16,4	0.64	63	2.48	42,0001,4080			standard MTG 320i
		15	0.59	25	0.98	18,6	0.73	61	2.40	42,0001,4496	AI		
		15	0.59	25	0.98	18,6	0.73	63	2.48	42,0001,4051			standard MTW 400i
		17	0.71	25	0.98	20,8	0.82	61	2.40	42,0001,4494	AI		
		17	0.71	25	0.98	20,8	0.82	63	2.48	42,0001,4050			standard MTW500i,330i W R long
		17	0.71	27	1.06	20,8	0.82	63	2.48	42,0001,4216			MTW 500i, heavy duty
		21	0.82	25	0.98	25,0	0.98	63	2.48	42,0001,4054			
		15	0.59	25	0.98	18,6	0.73	68	2.68	42,0001,4052			
		17	0.71	25	0.98	20,8	0.82	68	2.68	42,0001,4049			
		13	0.51	25	0.98	16,4	0.64	71	2.80	42,0001,4087			
		15	0.59	25	0.98	18,6	0.73	71	2.80	42,0001,4788			
		13	0.51	25	0.98	16,4	0.64	73	2.87	42,0001,4088			
15	0.59	25	0.98	18,6	0.73	73	2.87	42,0001,4475			standard MTB 400i G R		
15	0.59	27	1.06	18,6	0.73	73	2.87	42,0001,4790			MTB 400i G R, heavy duty		
15	0.59	25	0.98	18,6	0.73	73	2.87	42,0001,4495	AI				
15	0.59	25	0.98	18,6	0.73	75	2.95	42,0001,4045			standard MTG 400i		
17	0.71	25	0.98	20,8	0.82	75	2.95	42,0001,4043					
21	0.82	25	0.98	25,0	0.98	75	2.95	42,0001,4053					
15	0.59	25	0.98	18,6	0.73	80	3.15	42,0001,4047					

**TAB. 12**

		d1		d2		d3		L		Part No.		
		mm	inch	mm	inch	mm	inch	mm	inch			
MTB W400i W R H	M23x2	15	0.59	ø25	0.98	18,6	0.73	61	2.40	44,0350,3935		standard MTB 400i W R H
MTB W500i W R H		15	0.59	ø25	0.98	18,6	0.73	63	2.48	44,0350,1287		
		17	0.66	ø25	0.98	20,8	0.82	61	2.40	44,0350,3936		standard MTB 500i W R H

**TAB. 5**

MTB 700i  
MTW 750i

42,0402,0304  
Ø 25x1,5mm

42,0402,0305  
Ø 21x1,5mm

42,0402,0305  
Ø 21x1,5mm

	d1		d2		d3		L		Part No.		
	mm	inch	mm	inch	mm	inch	mm	inch			
①	17	0.66	ø29	1.10	22	0.86	71	2,79	44,0350,3966		Standard MTW 700i/750i
②	17	0.66	ø29	1.10	22	0.86	29	1.14	42,0001,4257		Standard MTW 700i/750i
①	17	0.66	ø29	1.10	22	0.86	76	3.00	44,0350,3942		HD
②	17	0.66	ø29	1.10	22	0.86	34	1.34	42,0001,4670		HD
①	17	0.66	ø29	1.10	22	0.86	68,5	2.70	44,0350,4079		Standard MTB 700i W R
②	17	0.66	ø29	1.10	22	0.86	26,5	1.04	42,0001,4868		Standard MTB 700i W R
①	17	0.66	ø29	1.10	22	0.86	69	2.72	44,0350,0226		Laser Hybrid
②	17	0.66	ø29	1.10	22	0.86	27	1.06	42,0001,0142		Laser Hybrid

# MTW 250i /FSC/3.5m/45° (4,035,945)

TAB. 6														
		d1		d2		d3		L		Part No.				
		mm	inch	mm	inch	mm	inch	mm	inch					
MTB G 330i R	MTB W 330i R	M23x2		13	0.51	ø25	0.98	16	0.63	37	1.46	42,0001,4533		not possible at MTB 330i G R H standard MTB 330i W R / G ML
		13	0.51	ø25	0.98	16	0.63	41	1.61	42,0001,4487				
		13	0.51	ø25	0.98	16	0.63	39,5	1.61	42,0001,4534	Al		standard MTB 330i G R   G R H	
		13	0.51	ø25	0.98	16	0.63	39,5	1.56	42,0001,4902				
		15	0.59	ø25	0.98	18	0.72	39,5	1.56	42,0001,5023				

TAB. 7												
		d1		d2		d3		L		Part No.		
		mm	inch	mm	inch	mm	inch	mm	inch			
MTB W 330i W R H	M23x2	13	0.51	ø25	0.98	16	0.63	41	1,61	42,0001,4486		standard MTB 330i W R H

TAB. 8													
		d1		d2		d3		L		Part No.			
		mm	inch	mm	inch	mm	inch	mm	inch				
MTB W 330i R MTB G 330i R	M23x2	narrow gap		13	0.51	ø25	0.98	16	0.63	56	2.21	42,0001,4745	
		13	0.51	ø25	0.98	16	0.63	50	1.97	42,0001,6772			

TAB. 9												
		d1		d2		d3		L		Part No.		
		mm	inch	mm	inch	mm	inch	mm	inch			
MTB G 330i R long	M23x2	13	0.51	ø27	1.06	18	0.72	53	2.09	42,0001,4858		standard MTB 330i G R
		15	0.59	ø27	1.06	18	0.72	53	2.09	42,0001,4857		
		15	0.59	ø27	1.06	18	0.72	57	2.09	42,0001,4856		

TAB. 10												
		d1		d2		d3		L		Part No.		
		mm	inch	mm	inch	mm	inch	mm	inch			
MTG 550i	M25x3	15	0.59	ø27	1.06	19	0.75	67	2.64	44,0350,2020		standard MTG 550i
		17	0.67	ø27	1.06	21	0.83	67	2.64	44,0350,2021		
		15	0.59	ø27	1.06	19	0.75	74	2.91	44,0350,1991		
		17	0.67	ø27	1.06	21	0.83	74	3.91	44,0350,1995		
		15	0.59	ø27	1.06	19	0.75	80,5	3.17	44,0350,1987		
		15	0.59	ø27	1.06	19	0.75	82,5	3.25	44,0350,1988		
		17	0.67	ø27	1.06	21	0.83	83,5	3.29	44,0350,3179		
		18	0.71	ø27	1.06	22	0.89	87,5	3.44	44,0350,3180		

TAB. 11												
		d1		d2		d3		L		Part No.		
		mm	inch	mm	inch	mm	inch	mm	inch			
MTB 400/500i W R MTB 320/400i G R	M23x2	13	0.51	ø25	0.98	16	0.63	62,5	2.46	42,0001,4917		standard MTB 320i G / 400/500i W
		10	0.39	ø25	0.98	16	0.63	68,0	2.68	42,0001,6715		
		13	0.51	ø25	0.98	16	0.63	68,0	2.68	42,0001,6716		standard MTB 400i G
		13	0.51	ø25	0.98	16	0.63	74,5	2.93	42,0001,4918		

TAB. 14												
		d1		d2		d3		L		Part No.		
		mm	inch	mm	inch	mm	inch	mm	inch			
MTG 400i	plug	15	0.51	ø25	0.79	19	0.63	69,5	2.91	42,0001,0972		standard MTB 400i G

TAB. 15												
		d1		d2		d3		L		Part No.		
		mm	inch	mm	inch	mm	inch	mm	inch			
MTW 500i	plug	17	0.66	ø27	1.06	22,2	0.87	85	3.34	44,0350,2036		standard MTB 500i W



# MTW 250i /FSC/3.5m/45° (4,035,945)

**Tab. 3**

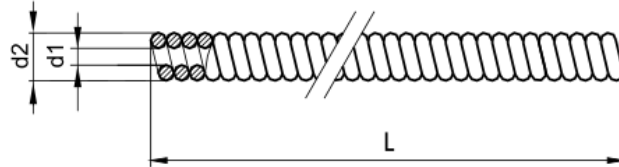

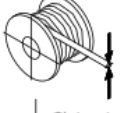
material			d1		d2		Part No. L		Part No. L	Part No. L		
	Ø mm	Ø inch	mm	inch	mm	inch	5m	16.4feet	15m	49.2feet	50m	160feet
Steel liner	0,8	.030	1,4	.055	4,4	.176	40,0002,0040,005		40,0002,0040,015		40,0002,0040,050	
Steel liner	0,9 - 1,0	.035/.040	1,6	.062	4,8	.189	40,0002,0041,005		40,0002,0041,015		40,0002,0041,050	
Steel liner	1,2	.045	1,9	.074	4,9	.192	40,0002,0042,005		40,0002,0042,015		40,0002,0042,050	
Steel liner	1,4 - 1,6	.052/.062	2,5	.098	4,9	.192	40,0002,0043,005		40,0002,0043,015		40,0002,0043,050	
CrNi liner	0,8	.030	1,4	.055	4,4	.176	40,0002,0044,005		40,0002,0044,015		40,0002,0044,050	
CrNi liner	0,9 - 1,0	.035/.040	1,6	.062	4,8	.189	40,0002,0045,005		40,0002,0045,015		40,0002,0045,050	
CrNi liner	1,2	.045	1,9	.074	4,9	.192	40,0002,0046,005		40,0002,0046,015		40,0002,0046,050	
CrNi liner	1,4 - 1,6	.052/.062	2,5	.098	4,9	.192	40,0002,0047,005		40,0002,0047,015		40,0002,0047,050	
Steel liner coated	0,8	.030	1,4	.055	4,4	.176	40,0002,0052,005		40,0002,0052,015		40,0002,0052,050	
Steel liner coated	0,9 - 1,0	.035/.040	1,6	.062	4,8	.189	40,0002,0053,005		40,0002,0053,015		40,0002,0053,050	
Steel liner coated	1,2	.045	1,9	.074	4,9	.192	40,0002,0054,005		40,0002,0054,015		40,0002,0054,050	
Steel liner coated	1,4 - 1,6	.052/.062	2,5	.098	4,9	.192	40,0002,0055,005		40,0002,0055,015		40,0002,0055,050	

**Tab. 3**

**combi liner W AL**

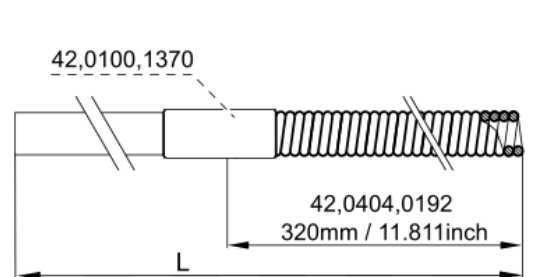
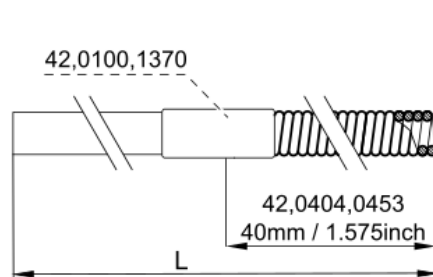
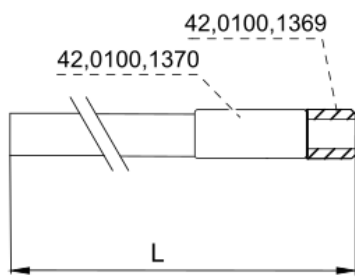

**combi liner G AL**

**combi inner liner G**

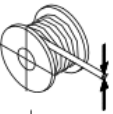

		L		d1		d2		combi liner W AL	combi liner G AL	combi inner liner G
Ø mm	Ø inch	m	feet	mm	inch	mm	inch	Part No.	Part No.	Part No.
0,8	.030	2,0	6.5	1,2	.059	4,7	.185	44,0350,3388	44,0350,3400	44,0350,5550
0,8	.030	3,8	12.4	1,2	.059	4,7	.185	44,0350,3392	44,0350,3404	44,0350,5513
0,8	.030	4,8	15.7	1,2	.059	4,7	.185	44,0350,3396	44,0350,3408	44,0350,5518
0,9 - 1,0	.035/.040	2,0	6.5	1,5	.062	4,7	.185	44,0350,3389	44,0350,3401	44,0350,5551
0,9 - 1,0	.035/.040	3,8	12.4	1,5	.062	4,7	.185	44,0350,3393	44,0350,3405	44,0350,5514
0,9 - 1,0	.035/.040	4,8	15.7	1,5	.062	4,7	.185	44,0350,3397	44,0350,3409	44,0350,5519
1,2	.045	2,0	6.5	1,8	0.74	4,7	.185	44,0350,3390	44,0350,3402	44,0350,5552
1,2	.045	3,8	12.4	1,8	0.74	4,7	.185	44,0350,3394	44,0350,3406	44,0350,5515
1,2	.045	4,8	15.7	1,8	0.74	4,7	.185	44,0350,3398	44,0350,3410	44,0350,5520
1,4 - 1,6	.052/.062	2,0	6.5	2,4	.098	4,7	.185	44,0350,3391	44,0350,3403	44,0350,5553
1,4 - 1,6	.052/.062	3,8	12.4	2,4	.098	4,7	.185	44,0350,3395	44,0350,3407	44,0350,5516
1,4 - 1,6	.052/.062	4,8	15.7	2,4	.098	4,7	.185	44,0350,3399	44,0350,3411	44,0350,5521
2,0	.045	2,0	6.5	1,2	.059	4,7	.185	44,0350,3615	44,0350,3618	44,0350,5554
2,0	.045	3,8	12.4	3,0	.118	4,7	.185	44,0350,3616	44,0350,3619	44,0350,5517
2,0	.045	4,8	15.7	3,0	.118	4,7	.185	44,0350,3617	44,0350,3620	44,0350,5522

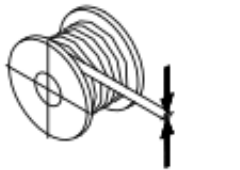
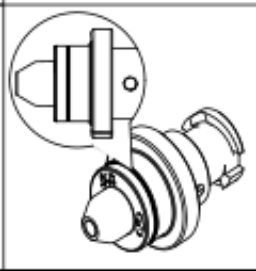
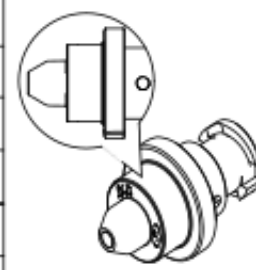
**MTW 250i / FSC/3.5m/45° (4,035,945)**

<b>Tab. 4</b>					
<b>MTG / MTW</b>					
 Ø mm   Ø inch		<b>Fe / CrNi</b>	<b>Alu / CuSi</b>	<b>colour</b>	
0,8	.031		44,0350,3314	grey	
0,8	.031	44,0350,3315		grey	
0,9-1,0	.039	44,0350,3317		blue	
1,2	.047	44,0350,3318		red	
1,4-1,6	.062	44,0350,3320		black	
2,0	.078		44,0350,3321	green	
2,4	.095		44,0350,4245	brown	
2,0	.078	42,0001,4589			
2,4	.095				
2,8	.110				

# MTW 250i /FSC/3.5m/45° (4,035,945)

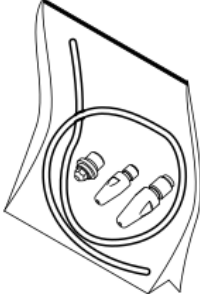
Basic kit 250i / 320i / 400i / 500i / 700i	Ø mm   Ø inch		m   feet		Fe MTG / MTW Part No.	CrNi MTG / MTW Part No.	Alu MTW Part No.	CuSi MTW Part No.	Alu/CuSi MTG Part No.
		0,6	.023	5,0	11.5	44,0350,5296	X	X	X
0,8		.030	5,0	11.5	44,0350,5117	44,0350,5158	44,0350,5135	44,0350,5144	
0,9		.035	5,0	14.8	44,0350,5118	44,0350,5159	44,0350,5136	44,0350,5145	
1,0		.040	5,0	11.5	44,0350,5119	44,0350,5160	44,0350,5137	44,0350,5146	
1,2		.047	5,0	14.8	44,0350,5120	44,0350,5161	44,0350,5138	44,0350,5147	
1,4		.052	5,0	11.5	44,0350,5121	44,0350,5162	44,0350,5139	44,0350,5148	
1,6		.062	5,0	14.8	44,0350,5122	44,0350,5163	44,0350,5140	44,0350,5149	
2,0		.078	5,0	14.8	X	X	44,0350,5141	X	

# MTW 250i /FSC/3.5m/45° (4,035,945)

## TOOLS

